

10.92
 4.37 10 2.92 10 2.75

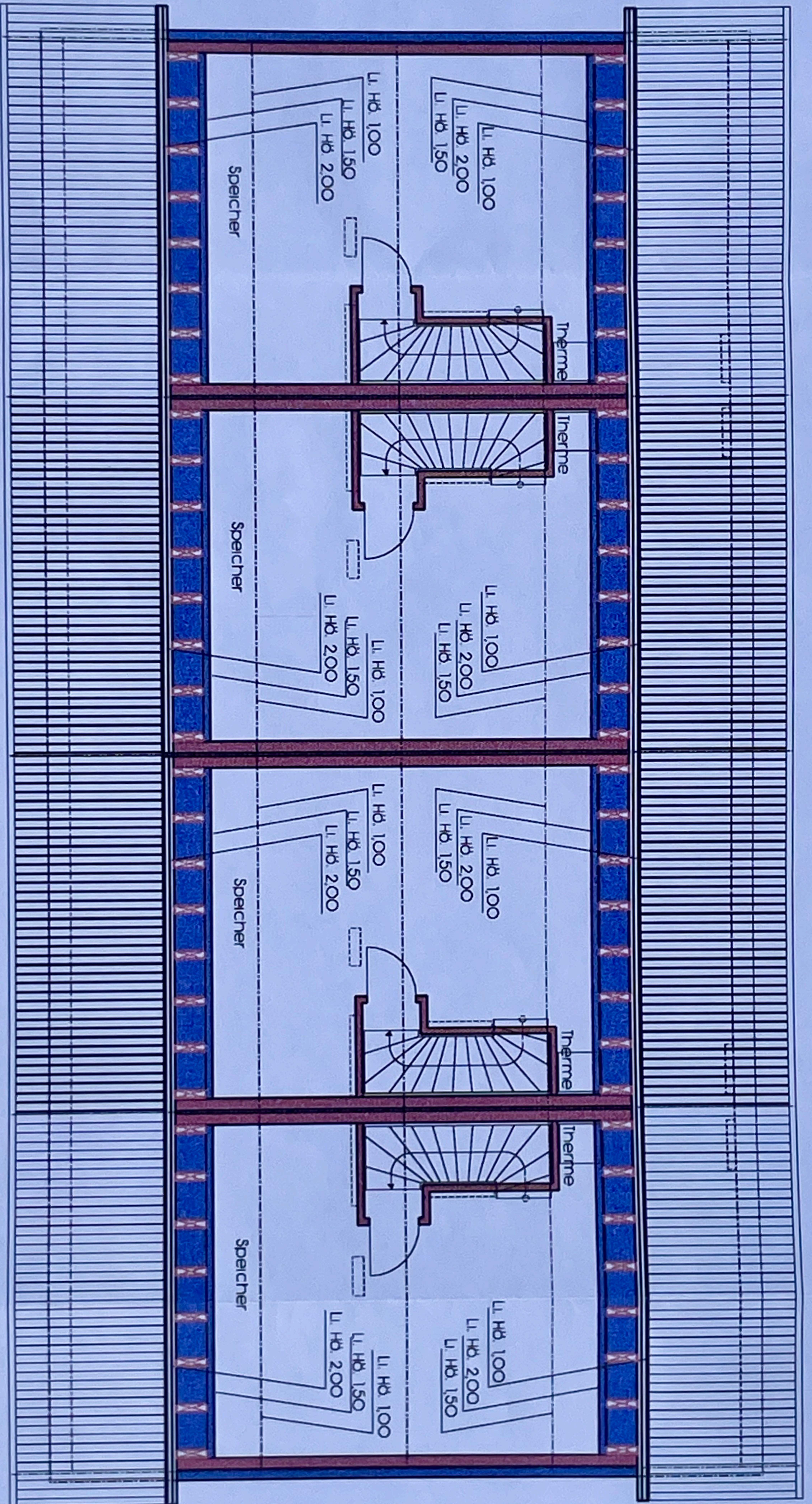

1.98
 2
 3.56
 5.10
 5.45
 5.50
 50
 104
 18
 18
 2
 2
 3.56
 5.10
 5.45
 5.50
 50
 104
 18
 18
 2
 2
 3.56
 5.10
 5.45
 5.50
 50
 104
 18
 18
 2
 2
 3.56
 5.10
 5.45
 5.50
 1.98
 2